

Bilbao Range

LED Wall Light



Product Information

The Bilbao range consists of a 12W 4000K LED plain wall light with the option of changing the standard cover to either an up and down, louvred or eyelid. Ideal for high saline and coastal areas.

Complete with 2 year warranty.

Product Features

- 2 year warranty
- Class II
- IP65
- 12w 4000K SMD LED
- Ra84
- Suitable for High Saline areas
- Non-Dimmable
- Instant On
- Can be mounted vertically or horizontally

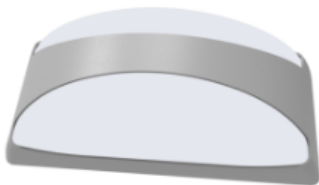

KSR1521

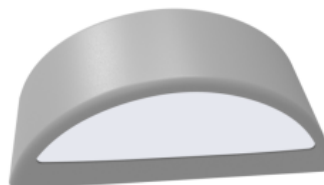

KSR1522



KSR1523

Product Specifications

Product Code	Product Description	Wattage (W)	Lumens (lm)	CRI (Ra)	CCT (K)	Energy Efficiency Class	Protection Class
KSR1520 GRY	Bilbao 12W LED Plain Grey Wall Light	12	940	84	4000	A	II

Product Code	Product Description	Lumens (lm) when fitted to KSR1520	LOR (%)
KSR1521 GRY	Bilbao Louvre Cover Only Grey	668	71.1
KSR1522 GRY	Bilbao Up and Down Cover Only Grey	335	35.7
KSR1523 GRY	Bilbao Eyelid Cover Only Grey	629	66.9

Nominal voltage	240V
Operating frequency	50Hz
IP rating	65
Amps	0.13
Start time	<0.5 sec

Construction

Body/Covers: 70% PC (Polycarbonate)/30% ABS (Acrylonitrile Butadiene Styrene)
Diffuser: PC (Polycarbonate)

Standards

BSEN60598-1:2015 Luminaires – Part 1: General requirements and tests

In Conformity with

LVD Low voltage directive 2014/35/EU
ERP Energy related products directive 2009/125/EC
RoHS Restriction of hazardous substances 2011/65/EU

Product Dimensions

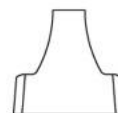
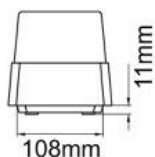
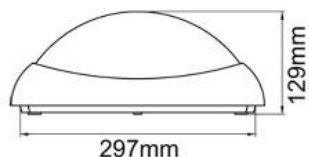
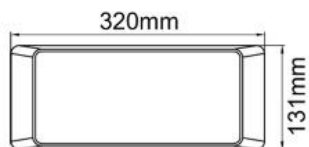

KSR1520

KSR1521

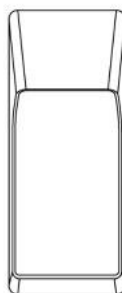
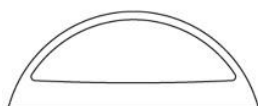

KSR1522

KSR1523

KSR Lighting is constantly developing and improving its products. For this reason, all product descriptions in this data sheet are intended as a general guide, and KSR may change specifications from time to time in the interest of product development, without prior notification or public announcement. All descriptions in this data sheet present only general particulars of the goods to which they refer and shall not form part of any contract. Data in this guide has been obtained in controlled experimental conditions. However, KSR Lighting cannot accept any liability arising from the reliance on such data to the extent permitted.