



Available finish: White

Read these instructions before commencing installation. Please give these instructions to the owner/occupier after installation to retain for future reference/maintenance.

IP44 240VAC~50Hz 0.5m GU10 35W Max.

These fittings are Class I and must be Earthed

**Important Information**

It is recommended that these luminaires are installed and fitted by a qualified electrician ensuring the installation complies with current IEE wiring regulations & local building control. These products are designed for connection to a 240VAC~50Hz supply. Any faulty, broken or damaged luminaires should be replaced immediately. KSR will not accept responsibility for any claims arising from a poor installation. Please Note: The limited warranty shall be deemed null and void in the following circumstances: Failure by the installer, end user or any third party to exercise caution to protect any covered product or part from outside damage, humidity conditions, fluctuations in the electrical system or physical abuse as well as failure related to workmanship in the installation of the products or parts.

**Important User Advice**

Always safely isolate the mains supply before installing, servicing or lamp replacement. Please note this luminaire is non-dimmable. General maintenance and cleaning should be performed at least quarterly. Clean product outer using a damp cloth, the glass can be cleaned with hot soapy water, dried and buffed to a shine. KSR recommend protecting from exposure to natural elements in the form of a non-abrasive water repellent protection (car wax). Grease screws and nuts with a suitable waterproof repellent will ensure the product gives you a long lasting trouble free life/finish. At the end of life the luminaire is classed as WEEE under directive 2014/30/EU and should be disposed of in accordance with local legislation.

**Installation Procedure**

Familiarize yourself with the luminaire, remove the two chrome dome nuts that secure the main fitting to the mounting plate. Set aside the dome nuts. Offer the base plate up to a suitable surface and mark the four fixing points, ensuring the drain holes are at the bottom of the plate (Fig. 1). Once drilled, dress the mains supply cable through the grommet and secure to the wall ensuring a water tight seal around the cable. Terminate the mains supply into the terminal block, following the markings on the fitting. Ensure the main gasket is seated correctly on the base plate and place the fitting onto it, grease the thread using a suitable water repellent grease, refit and tighten the dome nuts. Unscrew and remove the cap and fit a suitable GU10 lamp, if using GU10 LED lamp ensure they are suitable for enclosed housings. Refit the cap we recommend using a suitable water repellent grease to ease of future lamp changes, check the seal is in place and undamaged, fully tighten the cap to ensure a good water tight seal. Flip the small hood on the PIR settings, adjust the Time, Sensitivity, and Lux to suit, close the hood. Turn on the power and test the luminaire.

Fig.1

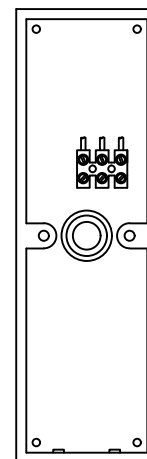

Base Section  
This Way Up

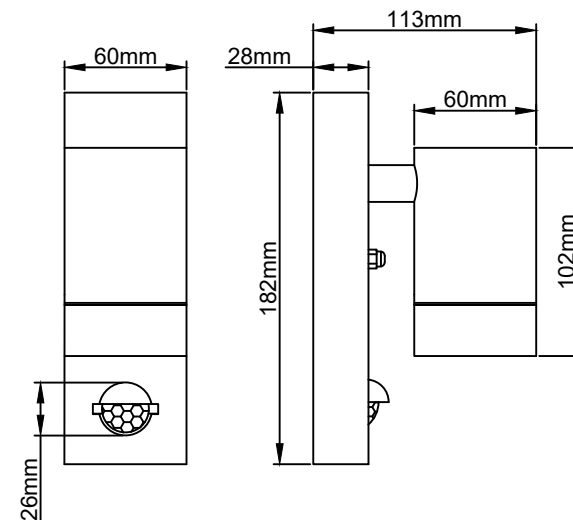

PIR Settings

Switch Time - 12 Sec to 4 Minutes  
Range - 9M when mounted at 4M  
Viewing Angle - 110°  
Minimum On Lux - 9 Lux

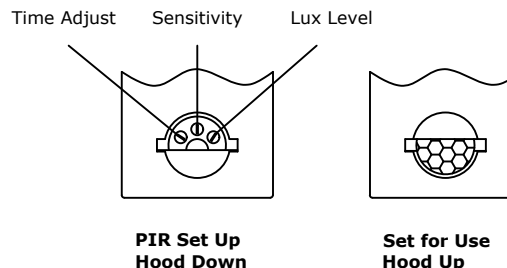

Mains Supply	Luminaire
Live - Brown	L- Brown
Earth - Green/Yellow	⊕ - Green/Yellow
Neutral - Blue	N - Blue

**Lamp Details**

Lamp Cap: GU10   
Max Wattage: 35W

Suitable for Retrofit LED Lamps



KSR Lighting Aftersales: 023 92 674343  
E-mail: aftersales@ksrlighting.com