

Read these instructions before commencing installation & retain them for future reference.

IP20 ☐ C € 240V

These Sensors are Class II and do not require an Earth connection

Important Information

It is recommended that luminaires are installed and fitted by a qualified electrician ensuring the installation complies with current IEE wiring regulations & local building control. These products are designed for connection to a 240V 50Hz supply. Any broken or damaged parts should be replaced as soon as possible. KSR will not accept responsibility for any claims arising from a poor installation.

Installation Guidelines

Remove the terminal cover and keep safe.
 Terminate your mains input cable into the L & N terminals, then connect the luminaire wires into the A & N terminals on the sensor. please note the Neutral terminal is shared for both input and output wiring.
 Replace the terminal cover and install into the ceiling void, a cut out of 63mm is required. On initial installation it is advised you leave the time setting to 10 Seconds and the Lux setting on the 'sun' symbol, with the sensitivity set to max (+) This will allow you to test and set up the sensor as required.
Time - This sensor can switch the lighting from a minimum of 10 Seconds to a maximum of 15 minutes, carefully turn the time dial to the required time.
Lux - This sensor will activate between daylight and 3 Lux, in order to achieve the required 'on' time it is recommended that the sensor is set to 30 Lux and wait 24 hours, after this period you can adjust the Lux control to up or down accordingly.
Sensitivity- The sensor will activate between 1m and 6m range, if the sensor triggers movement outside the required area, reduce the sensitivity to compensate.
Position - Ensure you position the sensor in a location suited to the the required activation point, this may not be central to any space. Avoid placing the sensor near heating vents or highly reflective surfaces as this may cause unwanted triggering.

Microwave Specification:

Mains Input - 220-240v AC
 Lux Control - 3-2000 Lux Adjustable
 Time Setting - Min 10 Seconds +/- 3 Second
 Max 12 Minutes +/- 1 Minutes
 Rated Load - LED, 300W
 Halogen, 1200W
 Frequency - 8.5GHz, ISM Band
 Detection Area - 360°
 Detection Distance - 1-8m Max
 Parasitic Power - 0.2W
 Installation Height - 1.5 - 3.5m

Mains Supply

Live - Brown -  A - Live
 Neutral - Blue -  N - Neutral

Out to Luminaire

A - Live
 N - Neutral

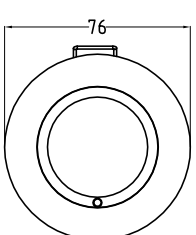
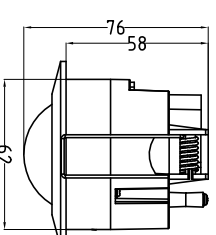
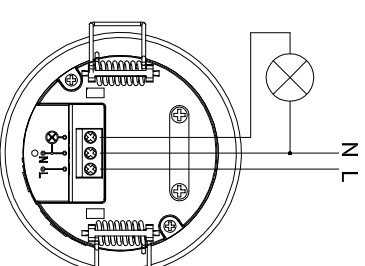
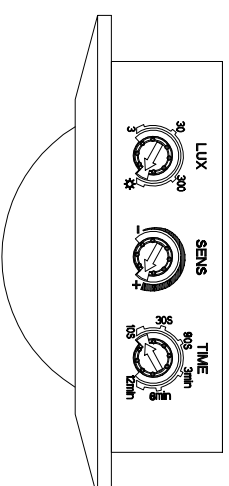
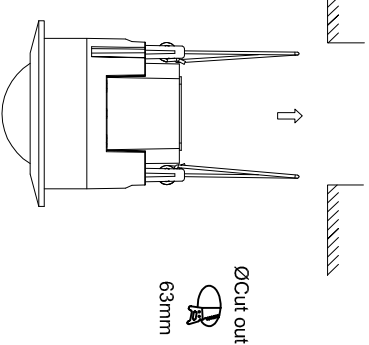
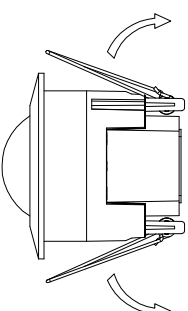

KSR
LIGHTING