



Read these instructions before commencing installation & retain them for future reference.

IP44  $\oplus$   $\ominus$   $\text{D}_{0.3m}$   $\text{W}$  240V 3W

These fittings are Class I and must be Earthed

### Important Information

It is recommended that luminaires are installed and fitted by a qualified electrician ensuring the installation complies with current IEE wiring regulations & local building control. These products are designed for connection to a 240V 50Hz supply. Any broken or damaged parts should be replaced as soon as possible. KSR will not accept responsibility for any claims arising from a poor installation.

### General Maintenance

General maintenance and cleaning should be performed at least quarterly. Clean product outer using a damp cloth, do not use abrasive cleaners as this may damage the finish. After any maintenance, remember to check all seals are intact.

### Installation Procedure

Familiarize yourself with the luminaire, and ensure the mains power is turned off before installation.  
 Remove the front cover and glass diffuser from the fitting.  
 Offer the luminaire up and mark the two fixing points, taking care not to damage other services drill the fixing holes.  
 Feed the mains supply cable through the grommet and secure the luminaire to the wall.  
 Terminate the wiring into the terminal block, ensuring correct polarity.  
 Ensure the earth cable is secured to the body of the luminaire using the dedicated connection point.  
 Replace the diffuser and front rim, do not overtighten these screws or distort the gasket.  
 Turn on the power and test the luminaire.

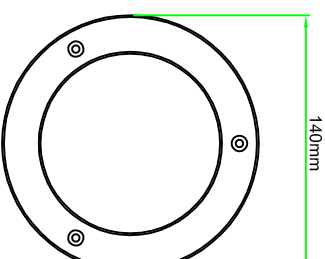
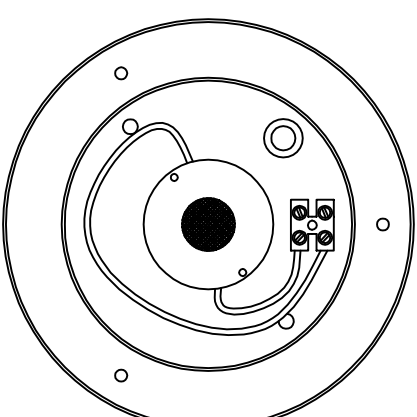

KSR1238

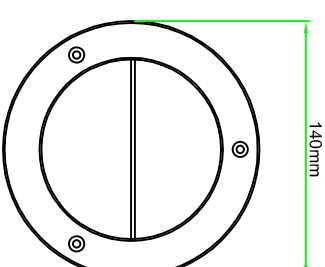

KSR1240

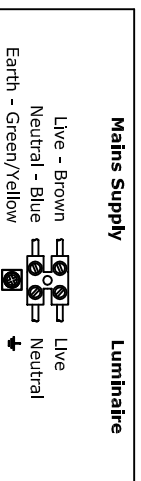

**Output Details**  
 KSR1238 - 3W Integral LED Module  
 KSR1240 - 3W Integral LED Module, Eyelid Cover  
 Non Replaceable  
 6000K Cool White

KSR Lighting Aftersales: 023 92 674343  
 E-mail: [info@ksr-lighting.co.uk](mailto:info@ksr-lighting.co.uk)

**KSR**  
 LIGHTING