

Read these instructions before commencing installation & retain them for future reference.

**IP44**   **€ 240V**

These Sensors are Class II and do not require an Earth connection

**Important Information**

It is recommended that luminaires are installed and fitted by a qualified electrician ensuring the installation complies with current IEE wiring regulations & local building control. These products are designed for connection to a 240V 50Hz supply. Any broken or damaged parts should be replaced as soon as possible. KSR will not accept responsibility for any claims arising from a poor installation.

**Installation Guidelines**

- Remove the Photocell dome by turning it in an anti-clockwise direction and pulling upward. Place in a safe location.
- Remove the inner socket to leave the main body of the Photocell, secure the main body to a suitable surface using the fixings provided.
- Dress your mains cable into the main body through the stuffing gland at the base of the sensor.
- Offer up the inner socket and connect your mains wiring following the guide opposite or below. Live In - L, Neutral - N & Live Out - LO.
- Seat the inner socket back into the main body, making sure the foam gasket is on place tighten the stuffing gland.
- Locate the dome back onto the main body and twist into place until you feel the two parts tighten.
- Turn on the power and test the Photocell, if in daylight simply fully cover the cell and wait approx. 1 minute for the lighting to come on.
- Location-** Ensure the Photocell is not located in a position where the artificial lighting it controls will illuminate it, this may cause the Photocell to switch off.

**PIR Specification:**

Mains Input - 110-240V AC  
 Lux Setting - 5-15 Non Adjustable  
 Rated Load - 10 Amp Max  
 Parasitic Power - 0.5W

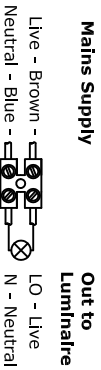

Available finish:- Black Finish

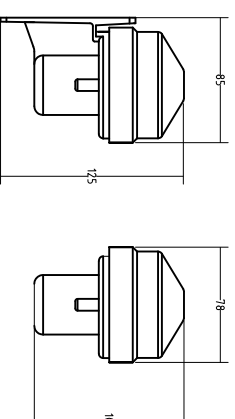
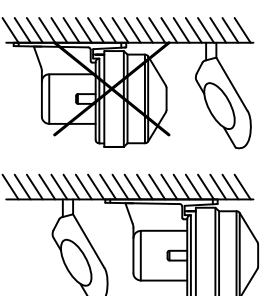
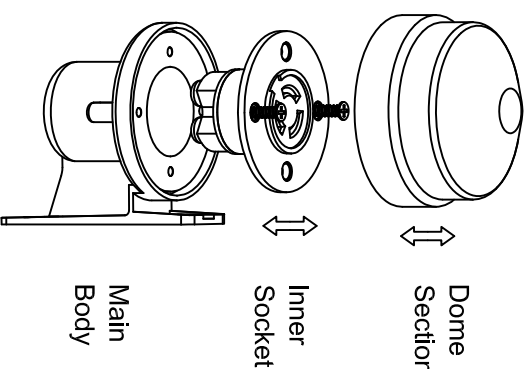
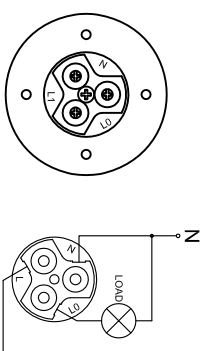
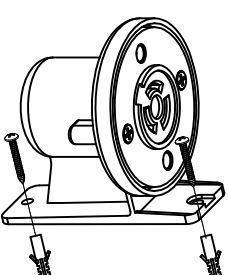
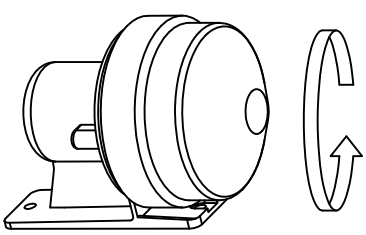

KSR Lighting Aftersales: 023 92 674343  
 E-mail: [info@ksr-lighting.co.uk](mailto:info@ksr-lighting.co.uk)