



Available Rims: White, Chrome and Satin Chrome

Read these instructions before commencing installation. Please give these instructions to the owner/occupier after installation to retain for future reference/maintenance.

IP54 IK06 UKA CE **240V~50Hz 12W**

These fittings are Class II and do not require an Earth

Important Information

It is recommended that these luminaires are installed and fitted by a qualified electrician ensuring the installation complies with current IEE wiring regulations & local building control. These products are designed for connection to a 240V~50Hz supply.

Any faulty, broken or damaged luminaires should be replaced immediately.

KSR will not accept responsibility for any claims arising from a poor installation.

Please Note: The limited warranty shall be deemed null and void in the following circumstances: Failure by the installer, end user or any third party to exercise caution to protect any covered product or part from outside damage, adverse temperature (normal operating ambient temperature -10°C - +30°C), humidity conditions, fluctuations in the electrical system or physical abuse as well as failure related to workmanship in the installation of the products or parts.

Important User Advice

Always switch off mains supply before servicing.

Do not use Megger or similar high voltage instruments. Due to the fact this luminaire contains electronic components that maybe damaged by high test voltages, they must be disconnected from the circuit before testing.

To prevent damage to the driver, do not mix with conventional magnetic ballasts on the same electrical circuit.

At the end of life the luminaire is classed as WEEE under directive 2014/30/EU and should be disposed of in accordance with local legislation.

Installation Procedure

Isolate mains supply before installation.

Loosen locking screw located on side wall of body

With screw loosened twist diffuser anti clockwise and remove.

Pass intended supply cable(s) through the grommet ensuring a good quality seal around the cable(s) to preserve the IP54 rating never pass 2 cables through the same hole in the grommet as this will allow moisture to enter the luminaire through the gap between the cables reducing the IP rating to IP20.

Ensure the fixing surface is flat and even.

Fix base to the wall or ceiling using adequate fixings with regard to the type of substrate.

Ensure incoming cables are protected.

For KSRSF350 terminate wiring as per Fig.2, For KSRSF351 terminate wiring as per Fig.3

Select LED colour required using the toggle switch Fig. 4 on the LED board: Please Note never change the LED colour with the luminaire powered on as this can damage the luminaire. Make sure the seal is in place in the diffuser and undamaged.

Units fitted with a microwave sensor (KSRSF351) please see overleaf for microwave sensor settings and set up

Replace the diffuser re-secure with a clockwise twist followed by tightening the locking screw.

Turn on the mains supply and test luminaire.

If using an optional rim clip the rim over the diffuser.

*Please note: Depending on the amount of fittings on a circuit you may have to upgrade the breaker to a 'C' or 'D' type to avoid nuisance tripping.

Fig. 4

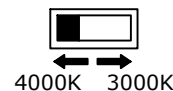
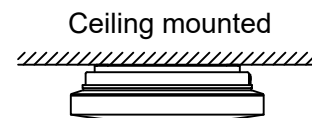

Fig. 1



Wall mounted

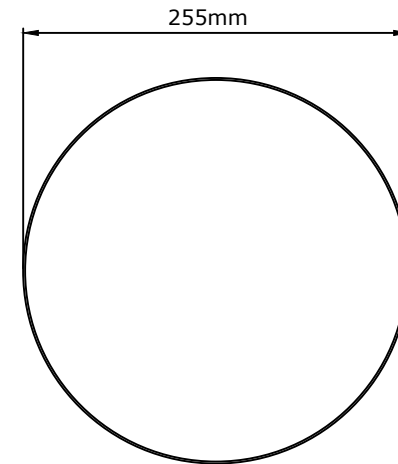
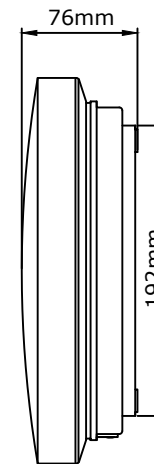
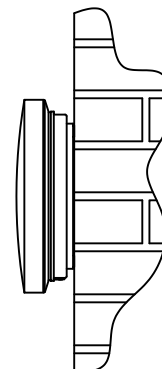

Fig. 2

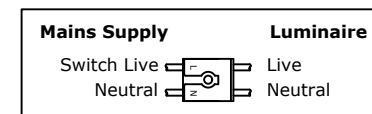
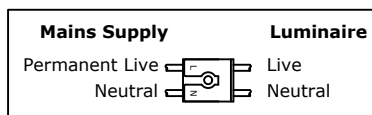

Fig. 3



Lamp Details

Lamp: LED
 Wattage: 12W
 Colour: 3000K and 4000K CCT
 Lumen Output:
 3000K - 1017 lumens
 4000K - 1147 lumens
 CRI: Ra>83

The light source of this luminaire is not replaceable; when the light source reaches its end of life the light source and control gear shall be replaced

KSR Lighting Aftersales: 023 92 674343
 E-mail: aftersales@ksrlighting.com





Read these instructions before commencing installation. Please give these instructions to the owner/occupier after installation to retain for future reference/maintenance.

IP54 IK06 UK CA CE □ 0.3m 240V~50Hz 12W

KSR Microwave On/Off Sensor Set Up Guide

1 - Detection Area

Detection area can be reduced by selecting the combination on the Dip Switches, following the guide as shown here.

	S1
100%	●
50%	○

2 - Hold Time

Hold time means the time period you would like the light to remain 'on' once no movement is detected.

	S2	S3
5s	●	●
1min	●	○
3min	○	●
5min	○	○

3 - Standby Level

Standby level can be set to dim between 100 - 10% or 100% - 0% (off) using the combination on the Dip Switches, following the guide as shown here.

	S4
10-100%	●
0-100%	○

4 - Daylight Sensor

The daylight sensor can be set to bring the light 'on' at specific daylight levels. To have the sensor function in daylight set the Dip Switches to Disable.

	S5
25Lux	●
Disable	○



This Microwave sensor is a motion activated switch, it will turn the light on when movement is detected, then hold the light on for the determined amount of time, after which the light will turn off.

Using the Dip Switches on the sensor, set it up to your preferred Detection area, Hold Time & Daylight level.

Please Note: Microwave sensors will detect movement through certain materials, if this occurs reduce the detection area to 50%.

