



# Bari

## LED Range

*Exterior Wall Lighting*

Data Sheet

### Product Information

The Bari LED wall lights are suitable for highlighting wall features for domestic applications. Also available in 2 versions a down light and an Up/Down light both available with Photocell sensors.

### Product Features

- 2 year warranty
- Class I
- IP65/IP54 – Photocell version
- 160° Beam angle
- CRI: Ra84
- 5w 3000K LED head
- Photocell Options Available
- L70/B30 – 25,000

## Product Specification

Product Code	Product Description	Wattage (W)	CCT (K)	Lumens (lm)	CRI (Ra)	Energy Efficiency Class	Protection Class
KSR1386	Bari 5w 3000K LED Single Wall Light	5w	3000	150	84	A+	I
KSR1387	Bari 5w 3000K LED Single Wall Light complete with photocell sensor	5w	3000	150	84	A+	I
KSR1388	Bari 2x5w 3000K LED Up & Down Wall Light	10w	3000	270	84	A+	I
KSR1389	Bari 2x5w 3000K LED Up & Down Wall Light complete with photocell sensor	10w	3000	270	84	A+	I

Technical Data	Bari Single	Bari Up & Down
Nominal voltage	220~240VAC	220~240VAC
Operating frequency	50Hz	50Hz
Circuit Wattage	5.7w	8.6w
Circuit Current	0.018A	0.036A
Driver mA Rating	210mA	210mA
PFC	0.61	0.61
In Rush Current	0.35A Max Peak	0.4A Max Peak
Ambient temperature range	-10°C to +30°C	-10°C to +30°C
IP rating	65/54	65/54

## Construction

Body: Cast Aluminium  
 Diffuser: Opal Polycarbonate

## Standards

BSEN60598-1:2015 Luminaires – Part 1: General requirements and tests

## In Conformity with

LVD Low voltage directive 2014/35/EU  
 EMC Electromagnetic compatibility directive 2014/30/EU  
 ERP Energy related products directive 2009/125/EC  
 RoHS Restriction of hazardous substances 2011/65/EU

# Product Dimensions

## KSR1386

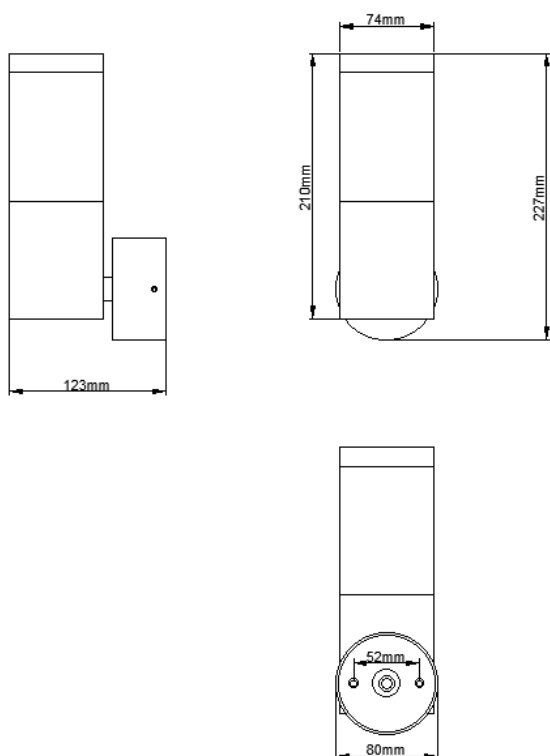

## KSR1387

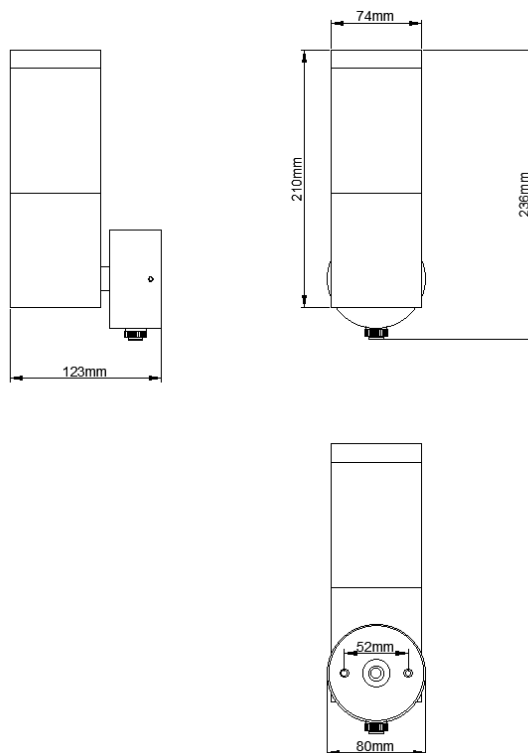

## KSR1388

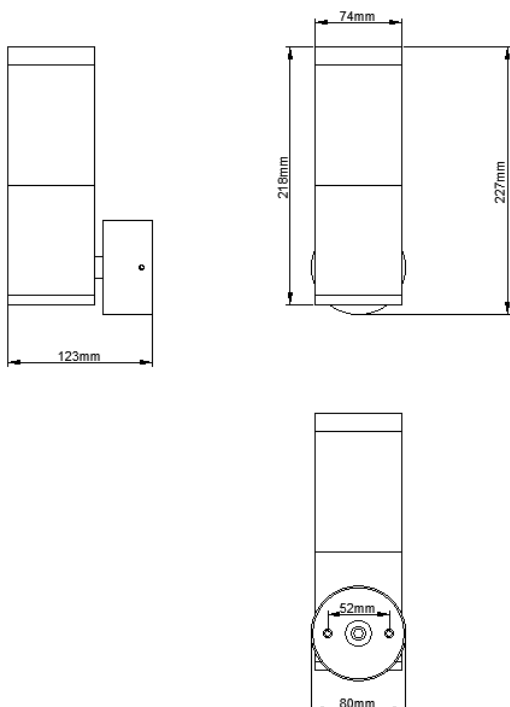

## KSR1389

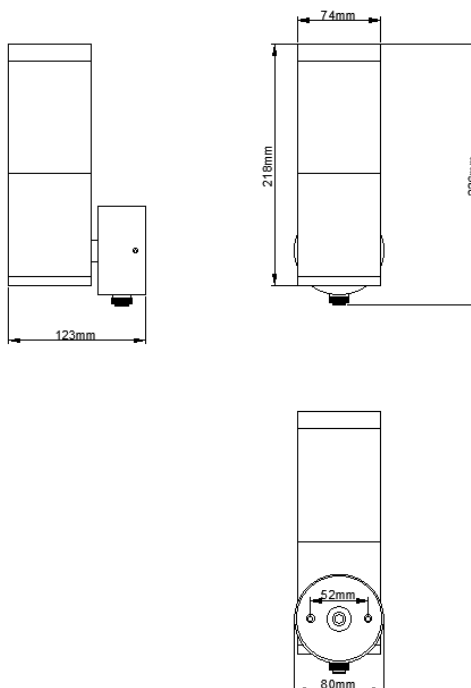

KSR Lighting is constantly developing and improving its products. For this reason, all product descriptions in this data sheet are intended as a general guide, and KSR may change specifications from time to time in the interest of product development, without prior notification or public announcement. All descriptions in this data sheet present only general particulars of the goods to which they refer and shall not form part of any contract. Data in this guide has been obtained in controlled experimental conditions. However, KSR Lighting cannot accept any liability arising from the reliance on such data to the extent permitted.