



Available Finish: Anthracite

Read these instructions before commencing installation. Please give these instructions to the owner/occupier after installation to retain for future reference/maintenance.

IP44 240VAC~50Hz 10W LED Max.

These fittings are Class I and must be Earthed

Important Information

It is recommended that these luminaires are installed and fitted by a qualified electrician ensuring the installation complies with current IEE wiring regulations & local building control. These products are designed for connection to a 240V~50Hz supply.

Any faulty, broken or damaged luminaires should be replaced immediately.

KSR will not accept responsibility for any claims arising from a poor installation.

Please Note: The limited warranty shall be deemed null and void in the following circumstances: Failure by the installer, end user or any third party to exercise caution to protect any covered product or part from outside damage, adverse temperature, humidity conditions, fluctuations in the electrical system or physical abuse as well as failure related to workmanship in the installation of the products or parts.

Important User Advice

Always safely isolate mains supply before installing/servicing.

KSR recommends a cleaning schedule at least quarterly using non abrasive cleaners. Also installing a water repellent grease on all serviceable screws.

Failure to install cable/grommets correctly can cause issues with excessive water ingress.

At the end of life the luminaire is classed as WEEE under directive 2014/30/EU and should be disposed of in accordance with local legislation.

Installation Procedure

Familiarize yourself with the luminaire/installation procedure and ensure the power is safely isolated before installing the luminaire.

Loosen the 2 grub screws that hold the fixing bracket to the body of the luminaire. Remove the bracket.

Fix the bracket Fig. 1 using suitable fixings for the substrate.

Remove the terminal cover by unscrewing and retaining the 4 screws. Using a thin sharp pointed object (i.e. bradawl) put a hole in the grommet and feed cable (maximum 8mm diameter) through ensuring the outer sheath is inside the terminal block and a good seal is maintained. Terminate cable as per Fig. 2, re-install the terminal cover ensuring the gasket seal is seated correctly, clean and undamaged. Do not over tighten the cover screws. This connector is not suitable for looping in and out.

Fit the luminaire to the fixing bracket (we recommend the use of a water repellent grease on all screws).

Ensuring that the 4 hex lampholder screws are at the bottom of the luminaire.

Remove the 4 hex screws from the base of the luminaire and carefully pull down the lampholder plate, install a suitable lamp and refit, ensuring you do not trap the cable. Secure with the retained 4 hex screws, do not over tighten (we recommend the use of a water repellent grease on all screws to aid future lamp changes).

Fig. 1

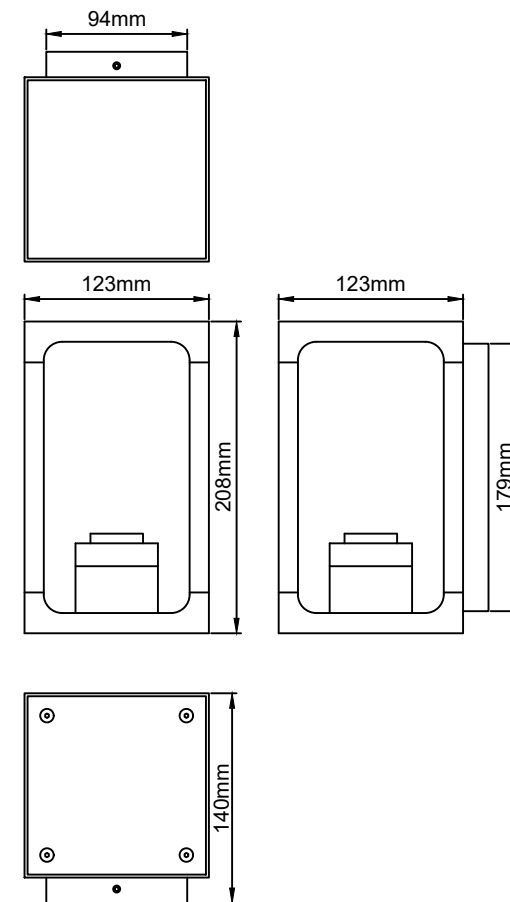
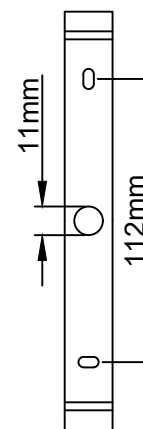
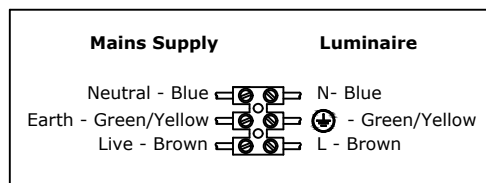

Fig. 2



Lamp Details

Lamp Cap: E27
 Maximum Wattage: 10W LED
 Maximum Lamp size:
 H140mm x W68mm



KSR Lighting recommend using branded lamps
 For example: Sylvania, GE, Philips or Osram

KSR Lighting Aftersales: 023 92 674343
 E-mail: aftersales@ksrlighting.com